

RoHS Compliant

REV	ECN No.	DATE	REMARK
A0	NEW	2024.6.3	NEW RELEASE

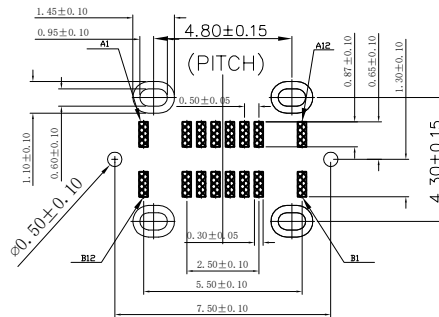
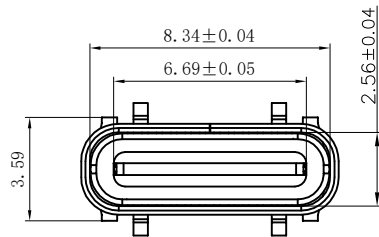
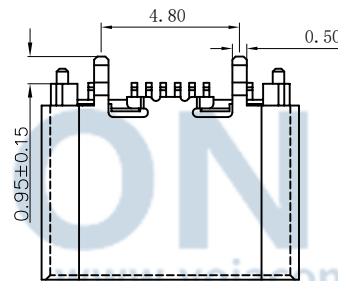
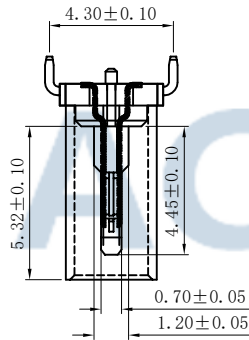
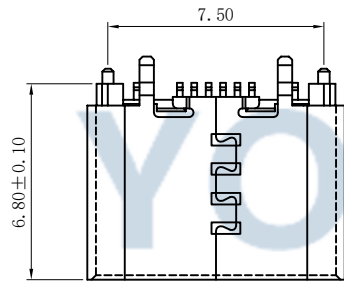
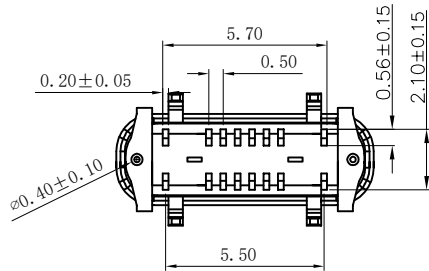

RECOMMENDED P.C.B. LAYOUT
TOLERANCE UNSPECIFIED ±0.05mm

1. 材料

- A. 主体: LCP, 黑色, UL 94-V0;
- B. 端子: H65铜, 电镀刷金;
- C. 外壳: 不锈钢201, 镀全镍;
- D. 卡钩: 不锈钢304;

2. 主要特性

- A. 电压等级: 20V AC;
- B. 电流: 3A;
- C. 工作温度: -40° c~85° c;

3. 电气要求:

- A. 接触电阻: 40mΩ Max, (初始), 50mΩ Max. (最后);
- B. 电压: 100V AC 1分钟;
- C. 绝缘电阻: 100MΩ min. DC 500v;

4. 机械性能:

- A. 插入力: 5~20N. (从1~10,000次);
- B. 拔出力: 8~20N. (从1~1,000次);
6~20N. (从1,001~10,000次);
- C. 耐久性寿命: 10,000次;

USB TYPE-C PIN ASSIGNMENTS

PIN NUMBER	SIGNAL NAME	PIN NUMBER	SIGNAL NAME
A1	GND	B12	GND
A4	VBUS	B9	VBUS
A5	CC1	B8	SBU2
A6	Dp1	B7	Dn2
A7	Dn1	B6	Dp2
A8	SBU1	B5	CC2
A9	VBUS	B4	VBUS
A12	GND	B1	GND

GENERAL TOLERANCES	
x.xxxxx	± ---
x.xxx	± 0.10
x.xx	± 0.25
x.x	± 0.30
ANGULAR	± --°

深圳市跃佳电子有限公司
SHENZHEN YOJACONN ELECTRONICS CO., LTD.

TITLE
TYPE-C母座 16P 立式四脚插 高6.8G3带夹片

DRAWN BY	XGC 2024.5.30	UNIT	MM	PART NO.	CF16V-4DS68G3-SN10
CHECKED BY	ZKX 2024.5.30	SIZE	A4	DWG NO.	CF16-003
APPROVED BY	LLQ 2024.6.3	SCALE	1:1	PROJECTION	SHEET 1 OF 1